

OWNER: 19 SWAHMI PROPERTIES PVT. LTD.  
 REPRESENTED BY: SRI ANVAY K. SINGHANIA  
 SBI ROAD, SILIGURI

PRINCIPAL USE - RESIDENTIAL  
 ARCHITECT: M. S. AGRAWAL & S. AGRAWAL  
 BARODA KOLKATA  
 SCALE: 1:300  
 DATE: 27/08/19  
 SHEET NO. - 1/25

29. FLAT MATRIX:  

| TYPE  | FLAT/MKG              | NO. PER FL. | TOTAL NO. |
|-------|-----------------------|-------------|-----------|
| 3B/3T | S.C.C.1/1             | 3           | 3         |
| 4B/4T | A.A.1/D.1/E.1/G.1/H.1 | 5           | 5         |
| 4B/5T | P.F.F.1               | 1           | 1         |

COND: "MAY APPROVED THE PLAN AND NOTICE" TO BE SUBMITTED TO THE LOCAL AUTHORITY FOR THE PROPOSED CONSTRUCTION OF THE BUILDING WITHIN THE PERMITTED ZONE.  
 PREVIOUS APPROVED BUILDING PLAN NO. - 394/BLDG DATE - 31/09/2019

*Signature: S. Agrawal*  
 S. AGRAWAL & S. AGRAWAL  
 BARODA KOLKATA

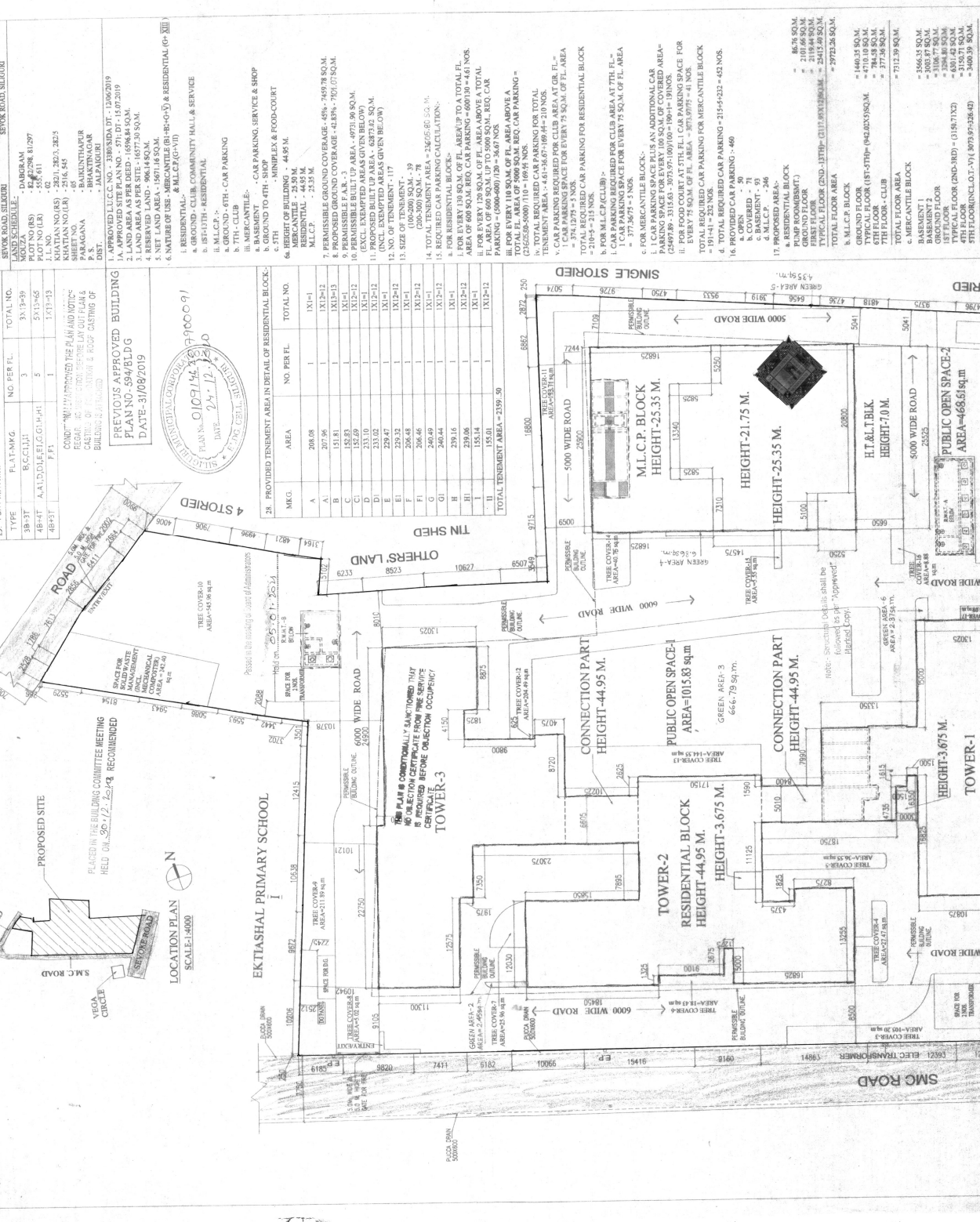

20. TOTAL BUILT UP AREA - (6873.02 - 246.76) SQ. M. = 6626.26 SQ. M. EXCL. EXEMPTED AREAS
21. CAR PARKING AREA (ADVANTAGE TAKEN) - 1264.9 SQ. M. = 1264.9 SQ. M. EXCL. EXEMPTED AREAS
22. PROPOSED F.A.R. = (6087.354 - 1088.44) SQ. M. = 5000.00 SQ. M.
23. TERRACE AREA - 448.40 SQ. M. = 448.40 SQ. M.
24. REQUIRED PUBLIC OPEN SPACE AREA (8.88%) = 1326.184 SQ. M.
25. REQUIRED TREE COVER AREA (20.00%) = 1326.184 SQ. M.
26. REQUIRED TOTAL PUBLIC OPEN SPACE AREA (8.88%) = 1326.184 SQ. M.
27. REQUIRED TREE COVER AREA (20.00%) = 1326.184 SQ. M.
28. REQUIRED TOTAL PUBLIC OPEN SPACE AREA (8.88%) = 1326.184 SQ. M.
29. REQUIRED TREE COVER AREA (20.00%) = 1326.184 SQ. M.
30. REQUIRED TOTAL PUBLIC OPEN SPACE AREA (8.88%) = 1326.184 SQ. M.
31. REQUIRED TREE COVER AREA (20.00%) = 1326.184 SQ. M.
32. REQUIRED TOTAL PUBLIC OPEN SPACE AREA (8.88%) = 1326.184 SQ. M.
33. REQUIRED TREE COVER AREA (20.00%) = 1326.184 SQ. M.
34. REQUIRED TOTAL PUBLIC OPEN SPACE AREA (8.88%) = 1326.184 SQ. M.
35. REQUIRED TREE COVER AREA (20.00%) = 1326.184 SQ. M.
36. REQUIRED TOTAL PUBLIC OPEN SPACE AREA (8.88%) = 1326.184 SQ. M.
37. REQUIRED TREE COVER AREA (20.00%) = 1326.184 SQ. M.
38. REQUIRED TOTAL PUBLIC OPEN SPACE AREA (8.88%) = 1326.184 SQ. M.
39. REQUIRED TREE COVER AREA (20.00%) = 1326.184 SQ. M.
40. REQUIRED TOTAL PUBLIC OPEN SPACE AREA (8.88%) = 1326.184 SQ. M.

1. APPROVED SITE PLAN NO. - 571-DT-15/07/2019  
 2. LAND AREA AS PER SITE - 1677.30 SQ. M.  
 3. NET LAND AREA - 966.14 SQ. M.  
 4. RESERVED LAND - 966.14 SQ. M.  
 5. NATURE OF USE - MERCANTILE (M-1) & RESIDENTIAL (R-1)

1. RESIDENTIAL - 100%  
 2. COMMERCIAL - 100%  
 3. INDUSTRIAL - 100%  
 4. AGRICULTURAL - 100%

1. APPROVED SITE PLAN NO. - 3880/SIDA/DT - 13/06/2019  
 2. LAND AREA AS PER SITE - 15/07/2019  
 3. NET LAND AREA - 966.14 SQ. M.  
 4. RESERVED LAND - 966.14 SQ. M.  
 5. NATURE OF USE - MERCANTILE (M-1) & RESIDENTIAL (R-1)

1. APPROVED SITE PLAN NO. - 571-DT-15/07/2019  
 2. LAND AREA AS PER SITE - 1677.30 SQ. M.  
 3. NET LAND AREA - 966.14 SQ. M.  
 4. RESERVED LAND - 966.14 SQ. M.  
 5. NATURE OF USE - MERCANTILE (M-1) & RESIDENTIAL (R-1)

1. RESIDENTIAL - 100%  
 2. COMMERCIAL - 100%  
 3. INDUSTRIAL - 100%  
 4. AGRICULTURAL - 100%

1. APPROVED SITE PLAN NO. - 571-DT-15/07/2019  
 2. LAND AREA AS PER SITE - 1677.30 SQ. M.  
 3. NET LAND AREA - 966.14 SQ. M.  
 4. RESERVED LAND - 966.14 SQ. M.  
 5. NATURE OF USE - MERCANTILE (M-1) & RESIDENTIAL (R-1)

1. RESIDENTIAL - 100%  
 2. COMMERCIAL - 100%  
 3. INDUSTRIAL - 100%  
 4. AGRICULTURAL - 100%

1. APPROVED SITE PLAN NO. - 571-DT-15/07/2019  
 2. LAND AREA AS PER SITE - 1677.30 SQ. M.  
 3. NET LAND AREA - 966.14 SQ. M.  
 4. RESERVED LAND - 966.14 SQ. M.  
 5. NATURE OF USE - MERCANTILE (M-1) & RESIDENTIAL (R-1)

1. RESIDENTIAL - 100%  
 2. COMMERCIAL - 100%  
 3. INDUSTRIAL - 100%  
 4. AGRICULTURAL - 100%

1. APPROVED SITE PLAN NO. - 571-DT-15/07/2019  
 2. LAND AREA AS PER SITE - 1677.30 SQ. M.  
 3. NET LAND AREA - 966.14 SQ. M.  
 4. RESERVED LAND - 966.14 SQ. M.  
 5. NATURE OF USE - MERCANTILE (M-1) & RESIDENTIAL (R-1)

1. RESIDENTIAL - 100%  
 2. COMMERCIAL - 100%  
 3. INDUSTRIAL - 100%  
 4. AGRICULTURAL - 100%

1. APPROVED SITE PLAN NO. - 571-DT-15/07/2019  
 2. LAND AREA AS PER SITE - 1677.30 SQ. M.  
 3. NET LAND AREA - 966.14 SQ. M.  
 4. RESERVED LAND - 966.14 SQ. M.  
 5. NATURE OF USE - MERCANTILE (M-1) & RESIDENTIAL (R-1)

1. RESIDENTIAL - 100%  
 2. COMMERCIAL - 100%  
 3. INDUSTRIAL - 100%  
 4. AGRICULTURAL - 100%